



Thriffs Mead, Theydon Bois, CM16

BUTLER & STAG



Guide Price £625,000 - £650,000.
Occupying a prime position in the heart of Theydon Bois village is this charming three bedroom semi-detached family home.



Freehold

- Three Bedroom Semi-Detached House
- Two Reception Rooms
- Two Bathrooms
- Off-Street Parking For Two Cars
- Chain Free
- 0.3 Miles To Theydon Bois Station

Accommodation is vast throughout with the floor space stretching just under 1500 sq ft. Comprising of a large living room with sliding doors leading into conservatory, kitchen/diner, utility room and a w/c completing the ground floor. Across the first floor there are three well proportioned bedrooms with en-suite to the master alongside a family bathroom.

Externally, the rear garden is partly block paved upon its entrance from the conservatory with steps leading up to the remainder of the garden which is then laid to lawn with borders. To the front there is off-street parking for two cars alongside access to the garage.

Theydon Bois is a charming village with a traditional green and duck pond, well regarded primary school, a range of shops, pubs and restaurants, cricket, tennis and golf clubs. Transport links to London are excellent with the central line tube station within ten minutes walk and easy access to the M25 and M11.





Thriffs Mead



Ground Floor

Approx. 78 Sq. meters (840 Sq. feet)

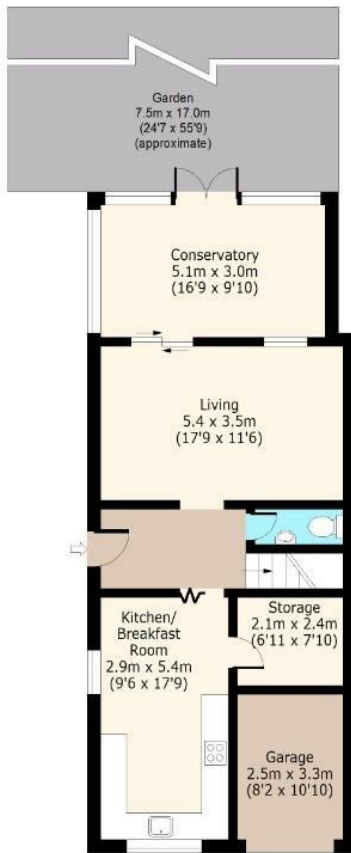

First Floor

Approx. 59 Sq. meters (635 Sq. feet)

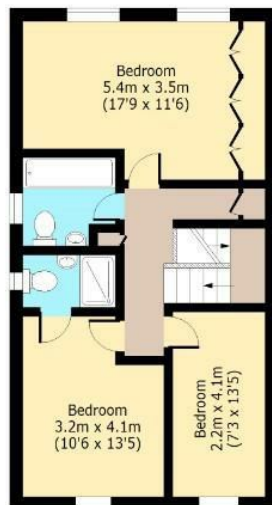

Total area: approx. 137 Sq. meters (1475 Sq. feet)

For illustration purposes only - not to scale

www.lpaplus.com

BUTLER & STAG

☎ 01992 667666

🏠 4 Forest Drive, Theydon Bois, Essex, CM16 7EY

✉ theydon@butlerandstag.com

www.butlerandstag.uk

IMPORTANT NOTICE - These particulars have been prepared in good faith and they are not intended to constitute part of an offer or contract. We have not performed a structural survey on this property and the services, appliances and specific fittings have not been tested. All photographs, measurements, floor plans and distances referred to are given as a guide and should not be relied upon.